

Pressure Reducing Regulator

PR, PS, PM, PH, PD, PL Series



FITOK Group

FITOK GmbH (Headquarter)
Sprendlinger Landstr. 115, 63069 Offenbach am Main, Germany
Tel.: +49 69 8900 4498 Fax: +49 69 8900 4495

FITOK, Inc.
13843 North Promenade Blvd., Suite 750, Stafford, Texas 77477, USA
Tel.: +1 281 888 0077 Fax: +1 281 582 4051

FITOK Incorporated
1-4F, Block C, Zone E, Yingtailong Industrial Park, Dalang Street,
Longhua District, Shenzhen, 518109, China
Tel.: +86 755 2803 2500 Fax: +86 755 2803 2619

FITOK Middle East Oil Equipment Trading LLC
208-209, Makateb Tower, Airport Road, P.O.Box 185412, Deira, Dubai, UAE
Tel.: +971 4 2959 853 Fax: +971 4 2959 854

info@fitokgroup.com
www.fitokgroup.com

FK-IC-SV-02-EN-140822

FITOK
Valves and Fittings

www.fitokgroup.com

Contents

Compact Pressure Reducing Regulator

PR Series 01

Extremely Sensitive Pressure Reducing Regulator

PS Series 06

Medium Flow Pressure Reducing Regulator

PM Series 11

General High Pressure Reducing Regulator

PH Series 16

Two-stage Pressure Reducing Regulator

PD Series 21

High Flow Pressure Reducing Regulator

PL Series 26

Compact Pressure Reducing Regulator

PR Series

PR series, single-stage diaphragm construction, stainless steel diaphragm pressure transmission, output stability, applied to pure gases, corrosive gases and non-corrosive gases.

Features

- ⦿ Compact
- ⦿ 316 stainless steel or brass body
- ⦿ Convoluted diaphragm provides accurate pressure adjustment
- ⦿ Metal-to-metal diaphragm seal
- ⦿ Spring loaded pressure reducing regulator
- ⦿ A filter installed in inlet
- ⦿ Panel mounting available



Technical Data

- ⦿ Maximum inlet pressure: 500, 3000 psig
- ⦿ Outlet pressure ranges: 0~25, 0~50, 0~100, 0~250, 0~500 psig
- ⦿ Flow coefficient (Cv):
500 psig Inlet pressure: 0.15
3000 psig Inlet pressure: 0.06
- ⦿ Working temperature: -40°F~+165°F (-40°C~+74°C)
- ⦿ Leak rate:
Internal: Bubble-tight
External: $\leq 2 \times 10^{-8}$ atm · cc/sec He
- ⦿ Weight: ≈ 1.98 lbs (0.9 Kg)
- ⦿ Ports: Inlet, Outlet, Gauge, Relief valve — 1/4" Female NPT

Flow Charts

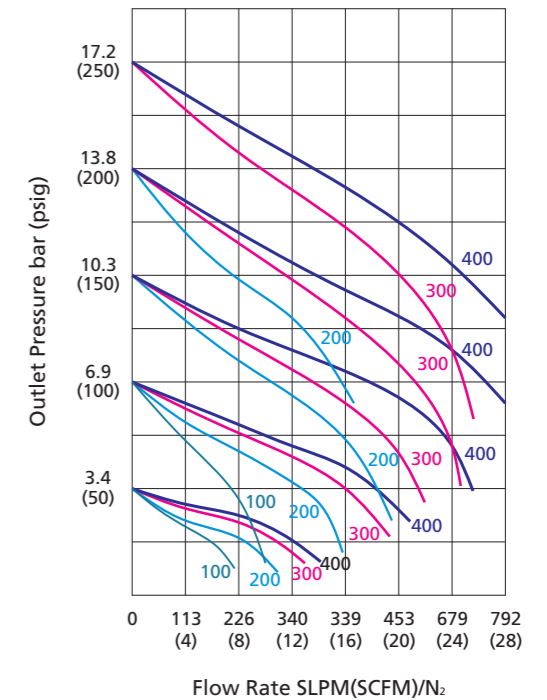
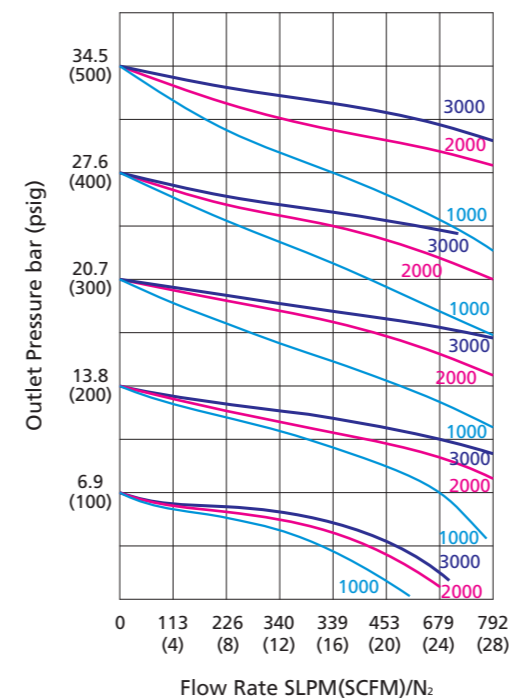

Normal Materials of Construction

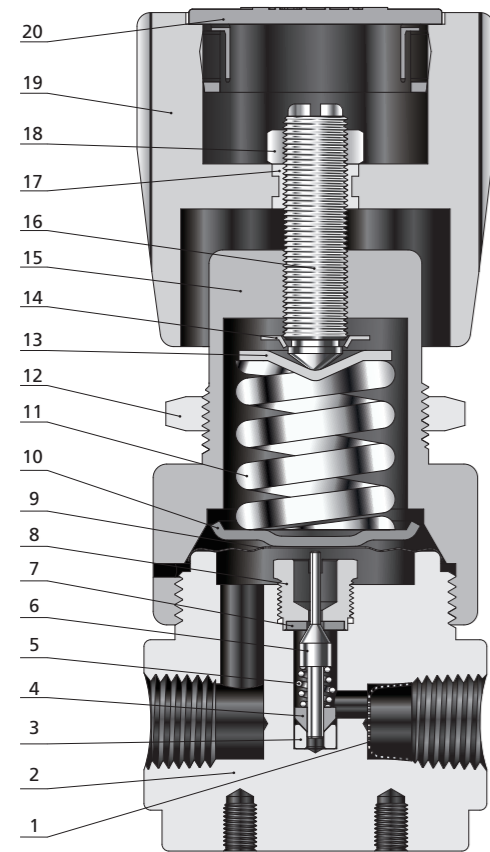

Component	Material Grade/ASTM Specification
1 Filter	316L SS
2 Body	316L SS/A479
3 Friction sleeve	316L SS/A276
4 Poppet damper	PTFE/D1710
5 Poppet spring	316L SS/A313
6 Lift poppet	316L SS/A276
7 Seat	PCTFE/D1430
8 Seat retainer	316L SS/A276
9 Diaphragm	316L SS/A240
10 Stop plate	304 SS/A240
11 Range spring	Alloy
12 Mounting nut	304 SS/A276
13 Spring button	304 SS/A240
14 Lock ring	304 SS/A240
15 Bonnet	304 SS/A479
16 Stem	C36000/B16
17 Embedded nut	C36000/B16
18 Stem nut	C36000/B16
19 Knob handle	ABS
20 Hole plug	ABS

Porting Configurations

6 Configurations as follows: A, B, C, D, E and F. All ports are 1/4" Female NPT.

HP: High pressure inlet LP: Low pressure outlet

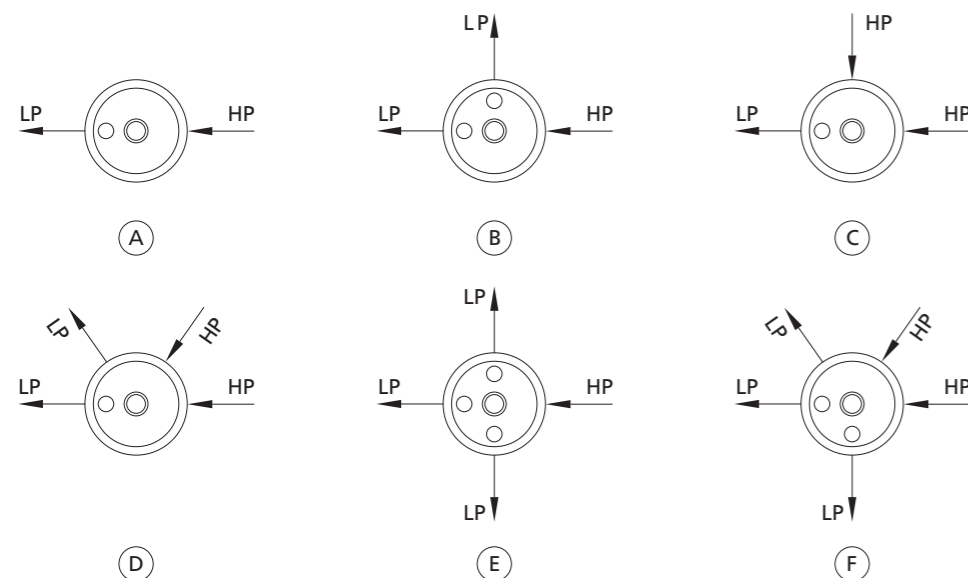

Dimensions

Dimensions, in. (mm), are for reference only and are subject to change.

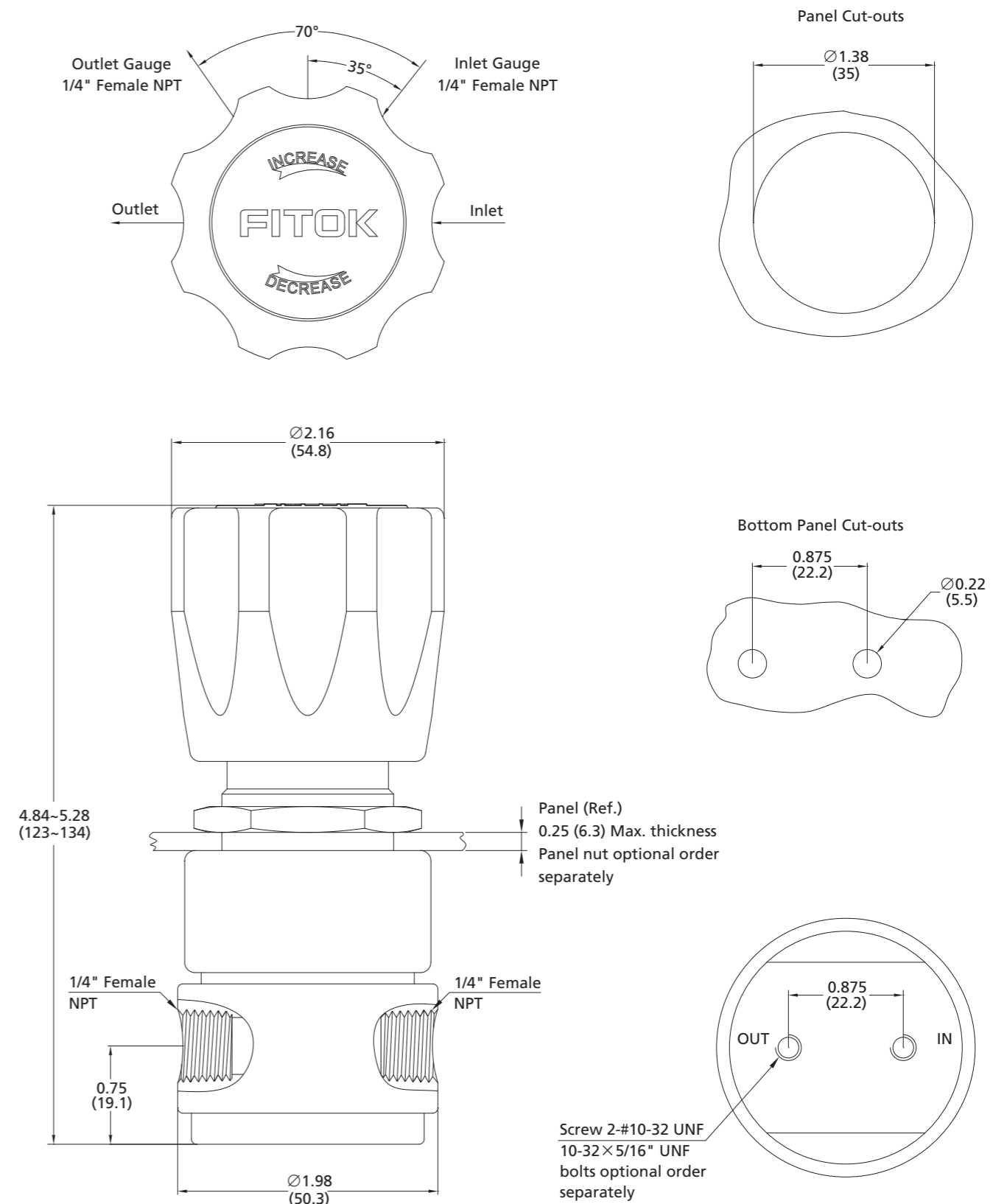

Ordering Number



Basic Ordering Number	Porting Configurations	Cv	Max. Inlet Pressure (psig)	Outlet Pressure Range (psig)
PR□ □ -F64MM-G10C-FL4-R	F	0.06	3000	0~250
PR□ □ -F63PP-G10-FNS4-R-F2				0~100
PR□ □ -F62BB-G10CLH-ML6-R				0~50

Basic Ordering Number	Porting Configurations	Cv	Max. Inlet Pressure (psig)	Outlet Pressure Range (psig)
PR□ □ -D64MM-FL4-N	D	0.06	3000	0~250
PR□ □ -D53BB-ML6-FNS4		0.15	500	0~100
PR□ □ -F62BP-FNS4-R	F	0.06	3000	0~50

Basic Ordering Number	Porting Configurations	Cv	Max. Inlet Pressure (psig)	Outlet Pressure Range (psig)
PR□ □ -A61WW-FNS4-Z	A	0.06	3000	0~25
PR□ □ -B63WB-FL4	B			0~100
PR□ □ -C52MW-FNS4-N	C	0.15	500	0~50
PR□ □ -E63WP-FNS4	E	0.06	3000	0~100

Note: The others are available, please contact FITOK group or authorized agent for the others.

Part Number Description

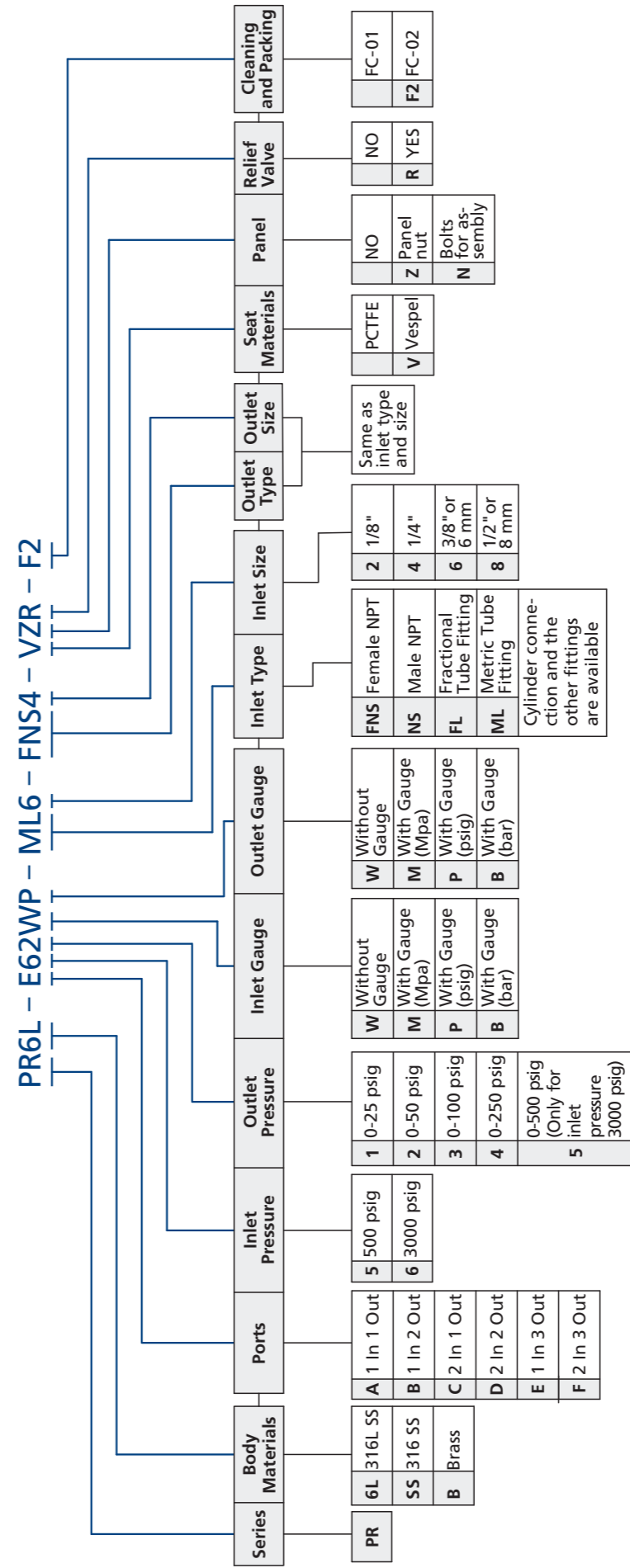

Note:

- "Part Number Description" is used for composition rules of FITOK product model, not suitable for specific product part number selection, not random combinations;
- The ports from body are 1/4" Female NPT, the other port types and sizes could be chosen with adapters, for further detail, please contact FITOK group or authorized agent;
- Gauge configurations description for regulator:
Pay attention to the ordering number cause the ports from body for gauges are one part of the total number. For further detail, please read the stylebook of gauge or contact FITOK group;
- Cleaning and Packing:
FC-01: Normal industry standard cleaning and packaging, following ASTM G93 level C.
FC-02: Special cleaning and packaging, following ASTM G93 level C.

Extremely Sensitive Pressure Reducing Regulator

PS Series

PS series, single-stage diaphragm construction, large convoluted diaphragm for extreme sensitivity, applied to pure gases, corrosive gases and non-corrosive gases.

Features

- ⦿ 316 stainless steel
- ⦿ Large convoluted diaphragm for extreme sensitivity
- ⦿ Metal-to-metal diaphragm seal
- ⦿ Extreme sensitivity: ±1% of outlet pressure range
- ⦿ Good repeatability
- ⦿ A filter installed in inlet
- ⦿ Panel mounting available

Technical Data

- ⦿ Maximum inlet pressure: 500, 3000 psig
- ⦿ Outlet pressure ranges: 0~25, 0~50, 0~100, 0~150, 0~200 psig
- ⦿ Flow coefficient (Cv):
500 psig Inlet pressure: 0.15
3000 psig Inlet pressure: 0.06
- ⦿ Working temperature: -40°F~+165°F (-40°C~+74°C)
- ⦿ Leak rate:
Internal: Bubble-tight
External: $\leq 2 \times 10^{-8}$ atm · cc/sec He
- ⦿ Weight: ≈ 3.08 lbs (1.4 Kg)
- ⦿ Ports: Inlet, Outlet, Gauge, Relief valve — 1/4" Female NPT



Normal Materials of Construction

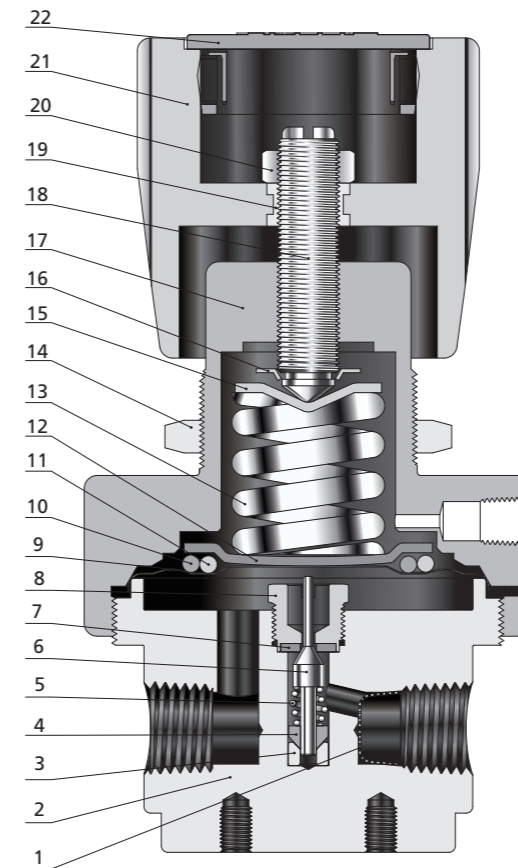

Component		Material Grade/ASTM Specification
1	Filter	316L SS
2	Body	316L SS/A479
3	Friction sleeve	316L SS/A276
4	Poppet damper	PTFE/D1710
5	Poppet spring	316L SS/A313
6	Lift poppet	316L SS/A276
7	Seat	PCTFE/D1430
8	Seat retainer	316L SS/A276
9	Diaphragm	316L SS/A240
10	O-ring	PTFE/D1710
11	O-ring	PTFE/D1710
12	Stop plate	304 SS/A240
13	Range spring	Alloy
14	Mounting nut	304 SS/A276
15	Spring button	304 SS/A240
16	Lock ring	304 SS/A240
17	Bonnet	304 SS/A479
18	Stem	C36000/B16
19	Embedded nut	C36000/B16
20	Stem nut	C36000/B16
21	Knob handle	ABS
22	Hole plug	ABS

Flow Charts

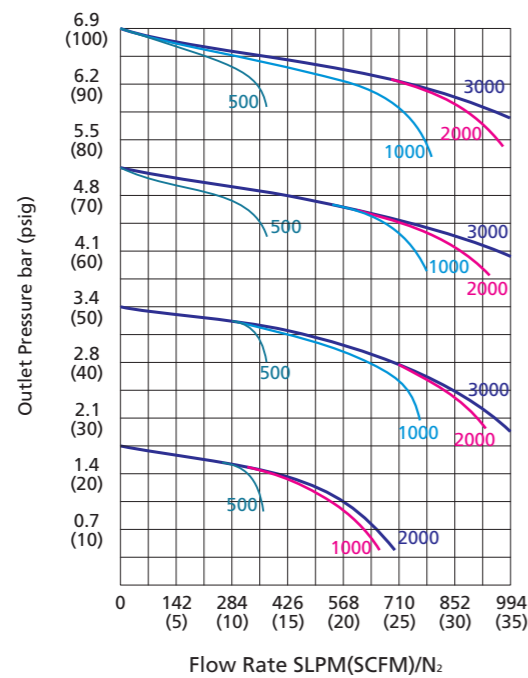

Porting Configurations

6 Configurations as follows: A, B, C, D, E and F. All ports are 1/4" Female NPT.

HP: High pressure inlet LP: Low pressure outlet

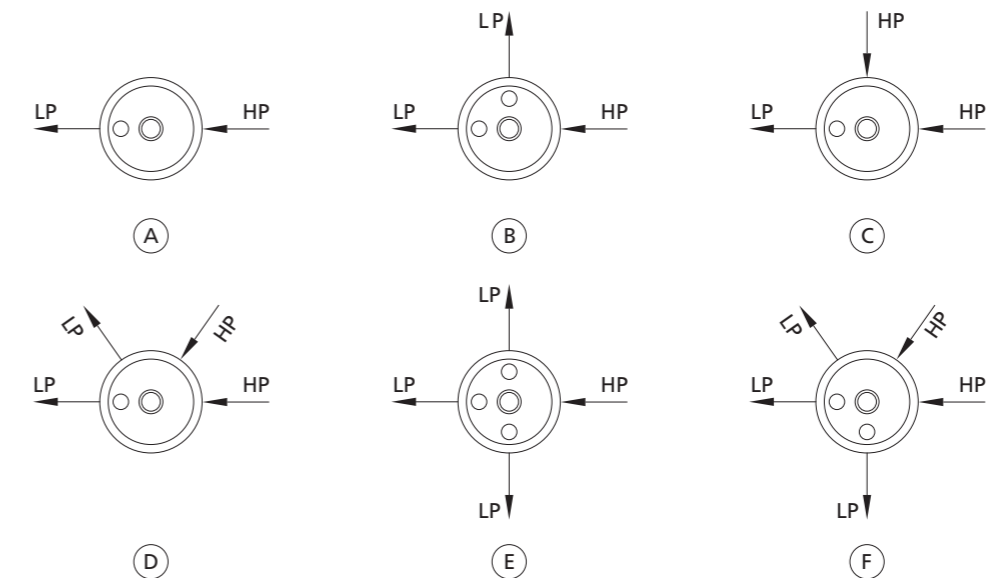

Dimensions

Dimensions, in. (mm), are for reference only and are subject to change.

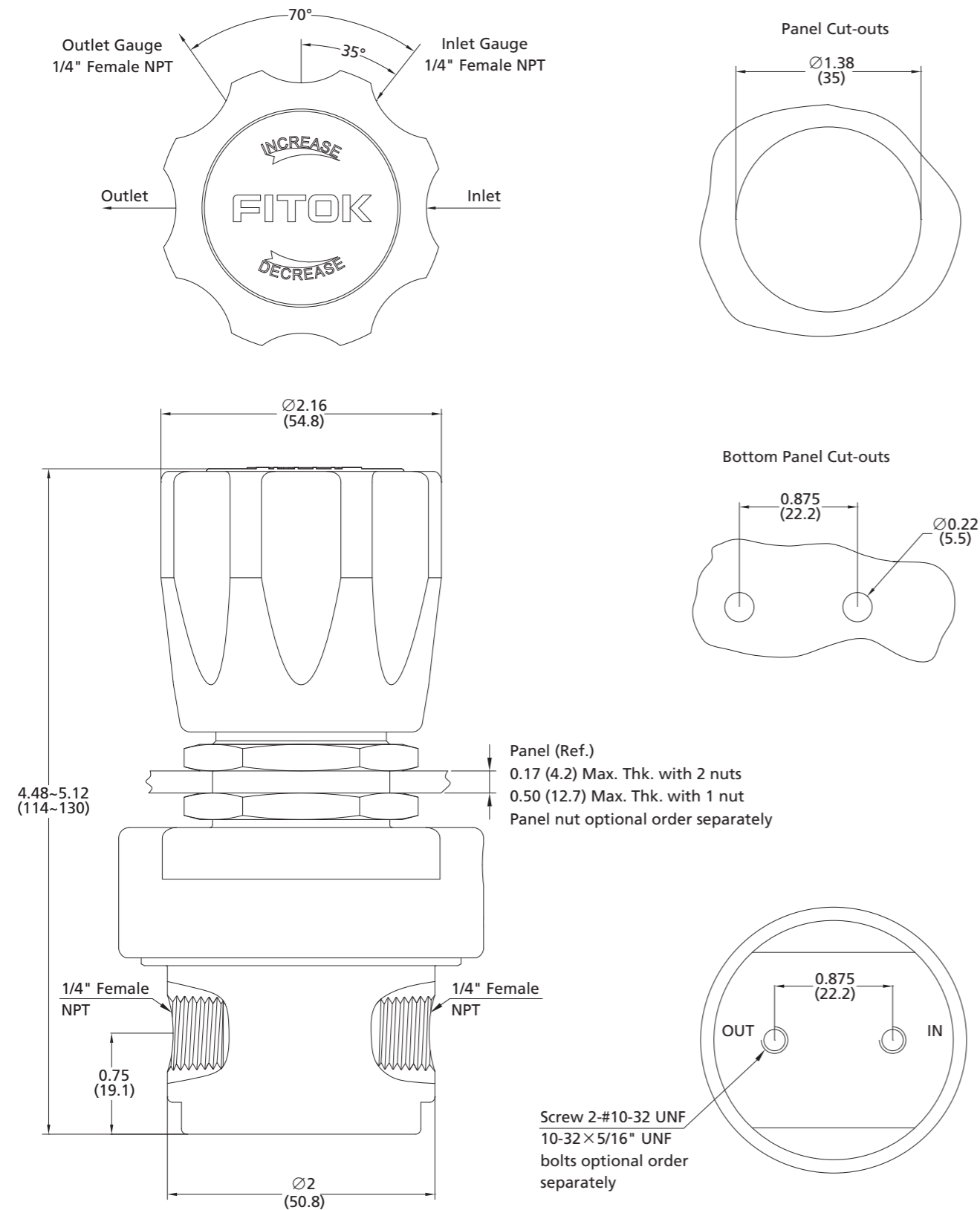

Ordering Number



Basic Ordering Number	Porting Configurations	Cv	Max. Inlet Pressure (psig)	Outlet Pressure Range (psig)
PS□ -F64BB-G10C-ML6-R-F2	F	0.06	3000	0~150
PS□ -F63PP-G10CLH-FL4-R				0~100
PS□ -F61PP-G10-FNS4-R				0~25

Basic Ordering Number	Porting Configurations	Cv	Max. Inlet Pressure (psig)	Outlet Pressure Range (psig)
PS□ -D64MM-FL4-N	D	0.06	3000	0~150
PS□ -D53PP-FL4-FNS4				0~100
PS□ -F51BP-FNS4-R-N	F	0.15	500	0~25

Basic Ordering Number	Porting Configurations	Cv	Max. Inlet Pressure (psig)	Outlet Pressure Range (psig)
PS□ -A63WW-FNS4-Z	A	0.06	3000	0~100
PS□ -B65WB-FL4	B			0~200
PS□ -C62MW-FNS4	C			0~50
PS□ -E53WP-FNS4-N	E	0.15	500	0~100

Note: The others are available, please contact FITOK group or authorized agent for the others.

Part Number Description

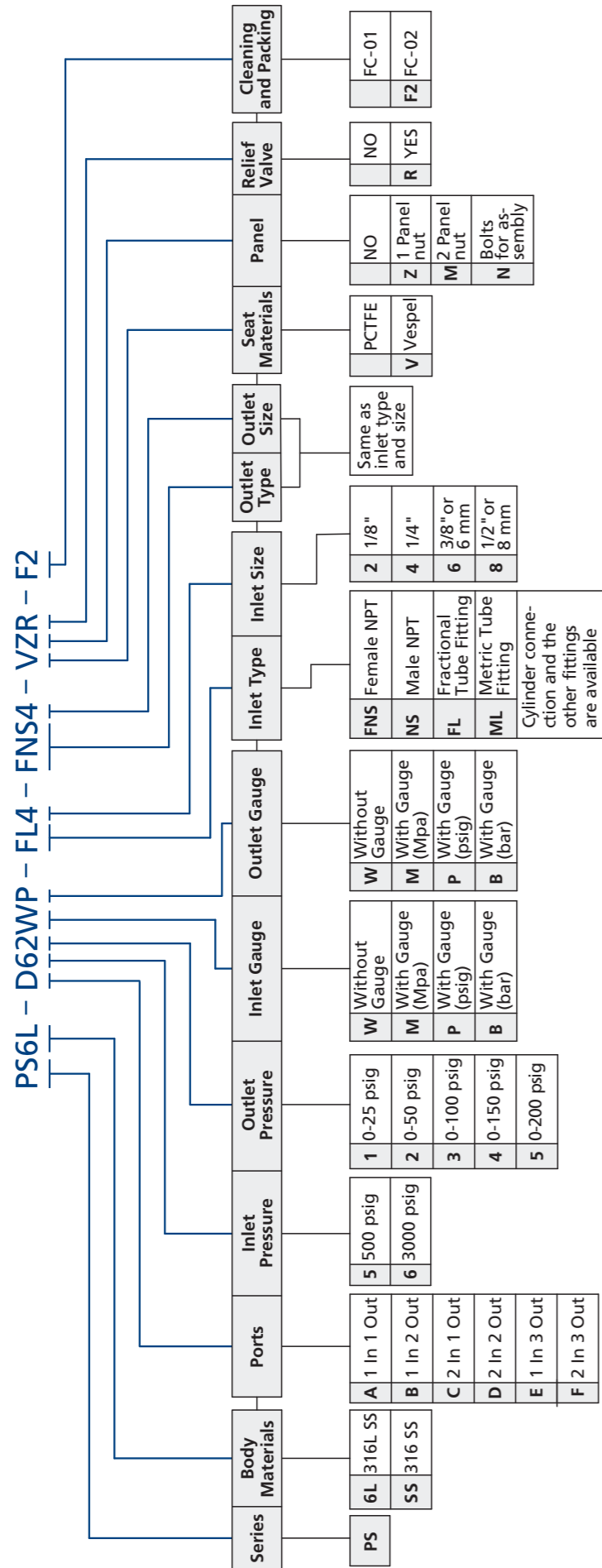

Note:

- "Part Number Description" is used for composition rules of FITOK product model, not suitable for specific product part number selection, not random combinations;
- The ports from body are 1/4" Female NPT, the other port types and sizes could be chosen with adapters, for further detail, please contact FITOK group or authorized agent;
- Gauge configurations description for regulator:
Pay attention to the ordering number cause the ports from body for gauges are one part of the total number.
For further detail, please read the stylebook of gauge or contact FITOK group;
- Cleaning and Packing:
FC-01: Normal industry standard cleaning and packaging, following ASTM G93 level C.
FC-02: Special cleaning and packaging, following ASTM G93 level C.

Medium Flow Pressure Reducing Regulator PM Series

PM series, single-stage diaphragm construction, stainless steel diaphragm pressure transmission, output stability, are mainly used in the gas systems with medium flow.

Features

- 316 stainless steel or brass body
- Large diameter convoluted diaphragm for increased pressure sensitivity
- Metal-to-metal diaphragm seal
- Large flow, minimal droop
- Panel mounting available

Technical Data

- Maximum inlet pressure: 500, 3000 psig
- Outlet pressure ranges: 0~25, 0~50, 0~100, 0~150, 0~200 psig
- Flow coefficient (Cv): 1.0
- Working temperature: -40°F~+140°F (-40°C~+60°C)
- Leak rate:
Internal: Bubble-tight
External: $\leq 2 \times 10^{-8}$ atm · cc/sec He
- Weight: ≈ 3.52 lbs (1.6 Kg)
- Ports: Inlet, Outlet — 1/2" Female NPT
Gauge, Relief valve — 1/4" Female NPT



Flow Charts

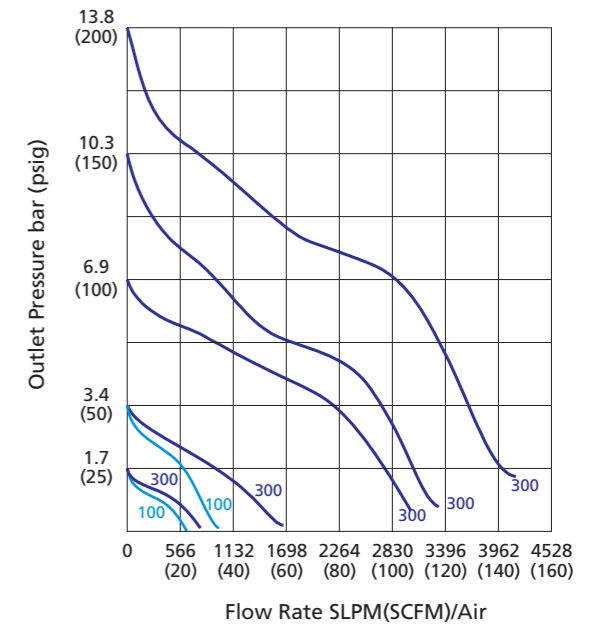
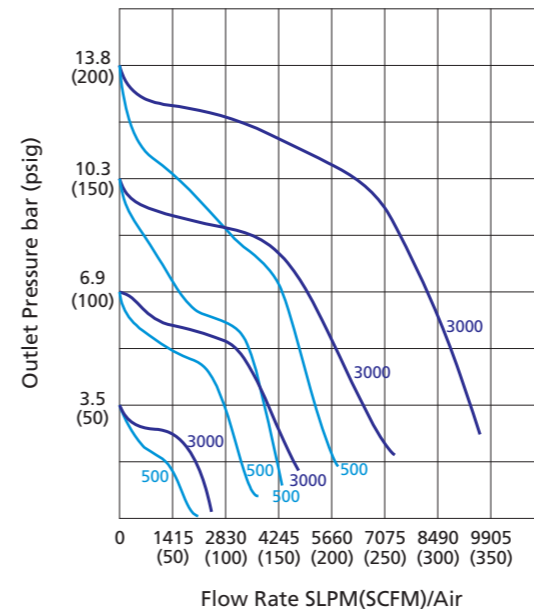

Normal Materials of Construction

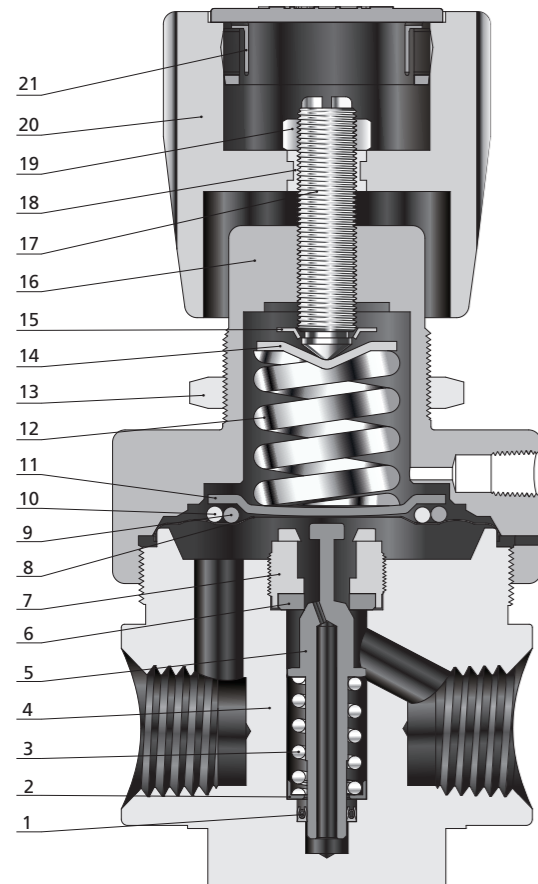

Component	Material Grade/ASTM Specification
1 Omniseal	PTFE+Stainless steel spring
2 Spring washer	316L SS/A276
3 Poppet spring	316L SS/A313
4 Body	316L SS/A479
5 Lift poppet	316L SS/A276
6 Seat	PCTFE/D1430
7 Seat retainer	316L SS/A276
8 Diaphragm	316L SS/A240
9 O-ring	PTFE/D1710
10 O-ring	PTFE/D1710
11 Stop plate	304 SS/A240
12 Range spring	Alloy
13 Mounting nut	304 SS/A276
14 Spring button	304 SS/A240
15 Lock ring	304 SS/A240
16 Bonnet	304 SS/A479
17 Stem	C36000/B16
18 Embedded nut	C36000/B16
19 Stem nut	C36000/B16
20 Knob handle	ABS
21 Hole plug	ABS

Porting Configurations

6 Configurations as follows: A, B, C, D, E and F. The horizontal inlet and outlet is both 1/2" Female NPT, the other ports are 1/4" Female NPT.

HP: High pressure inlet LP: Low pressure outlet

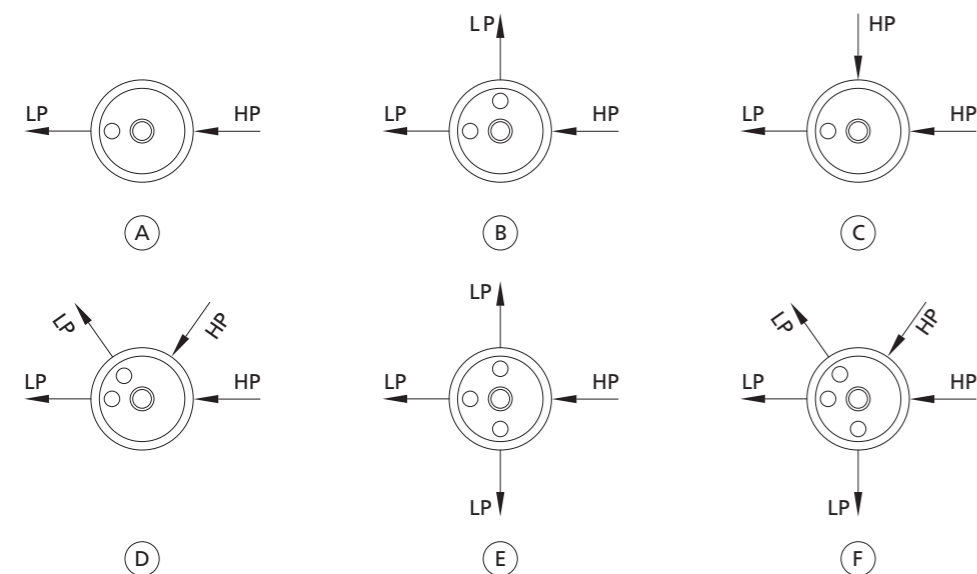

Dimensions

Dimensions, in. (mm), are for reference only and are subject to change.

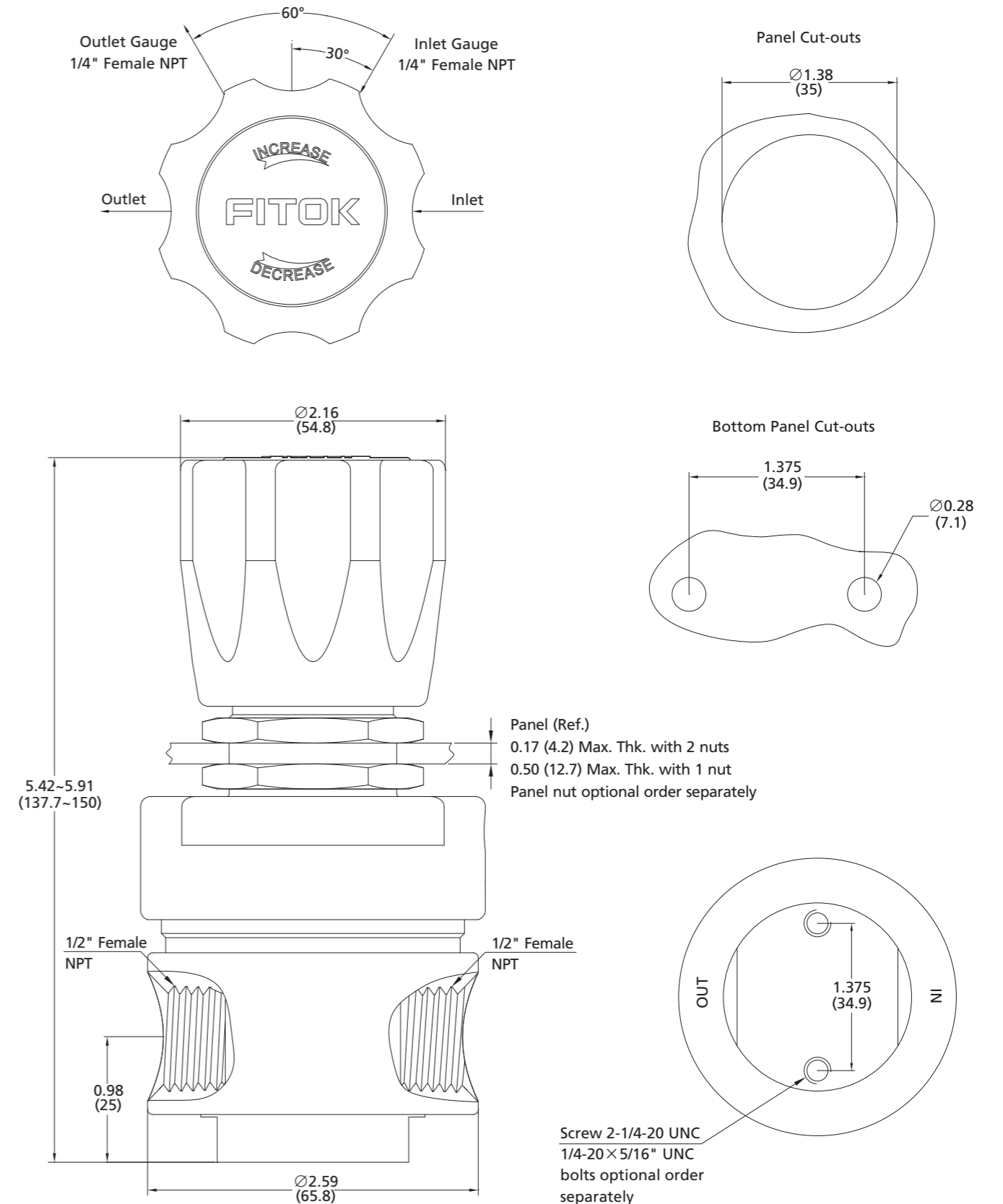

Ordering Number



Basic Ordering Number	Porting Configurations	Cv	Max. Inlet Pressure (psig)	Outlet Pressure Range (psig)
PM □ -F64BB-G10C-ML12-R	F	1.0	3000	0~150
PM □ -F63PP-G10CLH-FL8-R				0~100
PM □ -F61PP-G10-FNS8-R-F2				0~25

Basic Ordering Number	Porting Configurations	Cv	Max. Inlet Pressure (psig)	Outlet Pressure Range (psig)
PM □ -D65MM-FL8-ML12	D	1.0	3000	0~200
PM □ -D52PP-FL10-FNS8-N			500	0~50
PM □ -F54BB-FNS8-R	F			0~150

Basic Ordering Number	Porting Configurations	Cv	Max. Inlet Pressure (psig)	Outlet Pressure Range (psig)
PM □ -A61WW-FNS8-M	A	1.0	3000	0~25
PM □ -B64WB-FL10-ML14	B			0~150
PM □ -C52MW-FNS8-N	C		500	0~50
PM □ -E63WP-FNS8-FNS6-R	E		3000	0~100

Note: The others are available, please contact FITOK group or authorized agent for the others.

Part Number Description

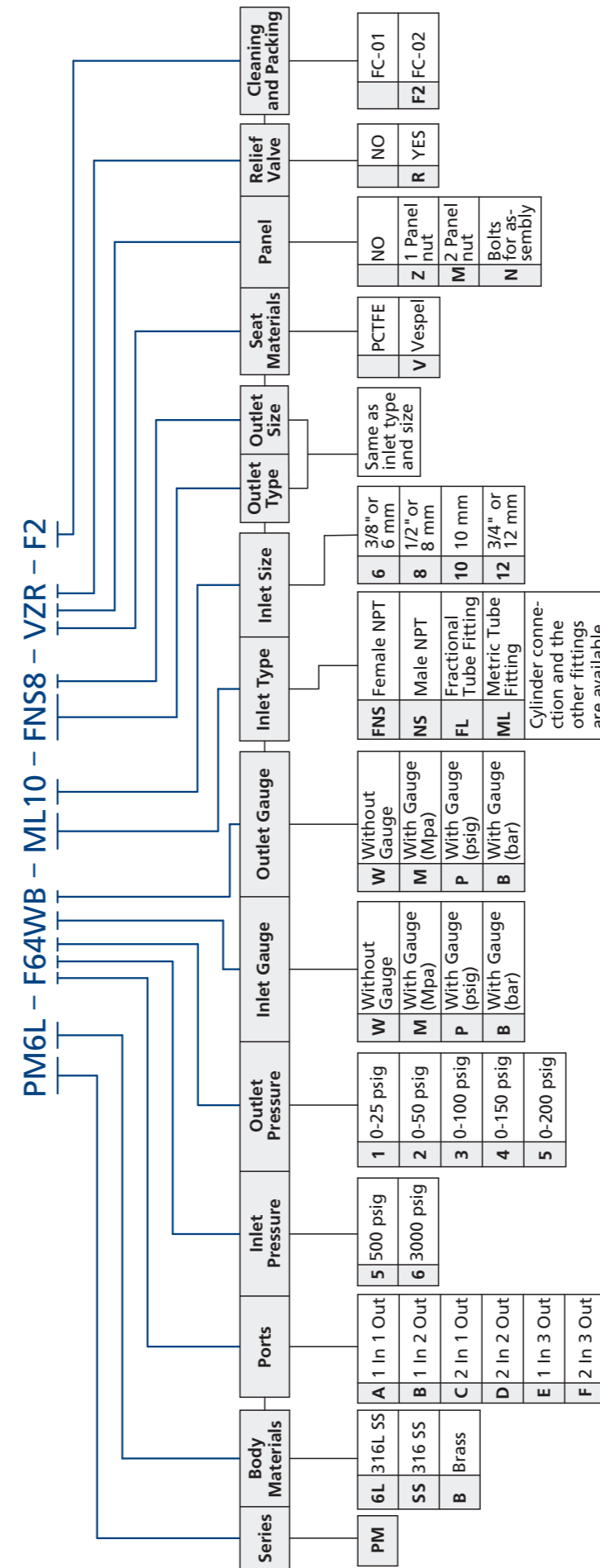

Note:

- "Part Number Description" is used for composition rules of FITOK product model, not suitable for specific product part number selection, not random combinations;
- The ports from body are according to the porting configuration, the other port types and sizes could be chosen with adapter, for further detail, please contact FITOK group or authorized agent;
- Gauge configurations description for regulator:
Pay attention to the ordering number cause the ports from body for gauges are one part of the total number. For further detail, please read the stylebook of gauge or contact FITOK group;
- Cleaning and Packing:
FC-01: Normal industry standard cleaning and packaging, following ASTM G93 level C.
FC-02: Special cleaning and packaging, following ASTM G93 level C.

General High Pressure Reducing Regulator

PH Series

The PH series is used for high pressure system, piston sensed construction, stability, applied to general gases, maximum 6000 psig inlet pressure and range of 0~2500 psig outlet pressure.

Features

- ⦿ Compact
- ⦿ 316 stainless steel or brass body
- ⦿ Robust piston sensed design
- ⦿ A filter installed in inlet
- ⦿ Venting model optional
- ⦿ Panel mounting available

Technical Data

- ⦿ Maximum inlet pressure: 3000, 6000 psig
- ⦿ Outlet pressure ranges: 0~250, 0~500, 0~1500, 0~2500 psig
- ⦿ Flow coefficient (Cv):
Non-vent: 0.06
Vent: 0.1
- ⦿ Working temperature: -15°F~+165°F (-26°C~+74°C)
- ⦿ Leak rate:
Internal: Bubble-tight
External: Bubble-tight
- ⦿ Weight: ≈1.98 lbs (0.9 Kg)
- ⦿ Ports: Inlet, Outlet, Gauge, Relief valve — 1/4" Female NPT



Normal Materials of Construction

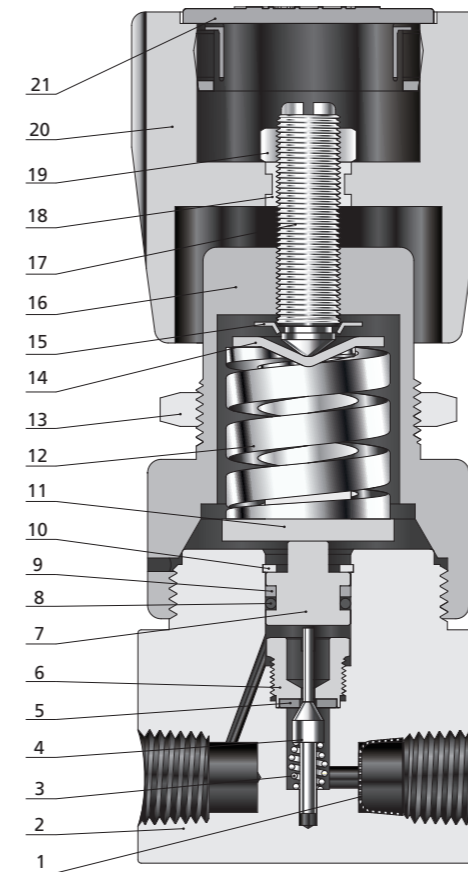

Component		Material Grade/ASTM Specification
1	Filter	316L SS
2	Body	316L SS/A479
3	Poppet spring	316L SS/A313
4	Lift poppet	316L SS/A276
5	Seat	PCTFE/D1430
6	Seat retainer	316L SS/A276
7	Piston	316L SS/A276
8	O-ring	Viton®
9	Retainer-ring	PTFE/D1710
10	Stretch block	304 SS
11	Spring seat	Brass
12	Range spring	Alloy
13	Mounting nut	304 SS/A276
14	Spring button	304 SS/A240
15	Lock ring	304 SS/A240
16	Bonnet	304 SS/A479
17	Stem	C36000/B16
18	Embedded nut	C36000/B16
19	Stem nut	C36000/B16
20	Knob handle	ABS
21	Hole plug	ABS

Flow Charts

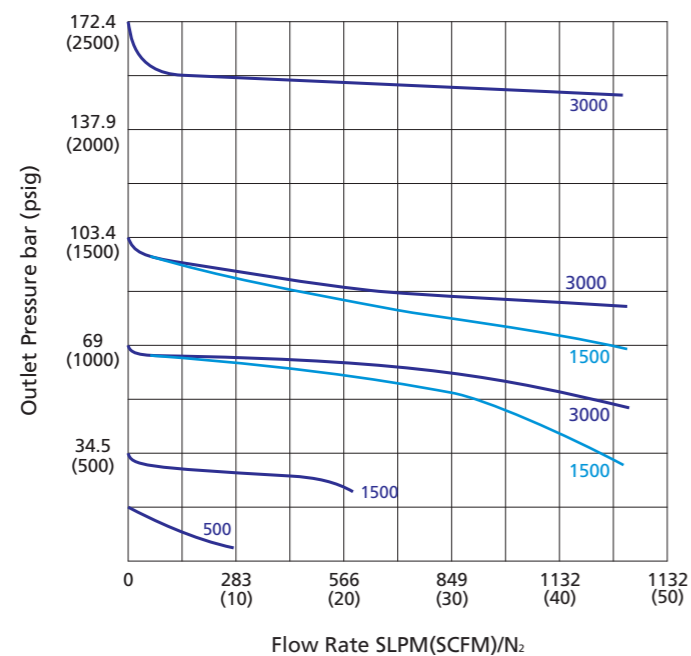

Porting Configurations

6 Configurations as follows: A, B, C, D, E and F. All ports are 1/4" Female NPT.

HP: High pressure inlet LP: Low pressure outlet

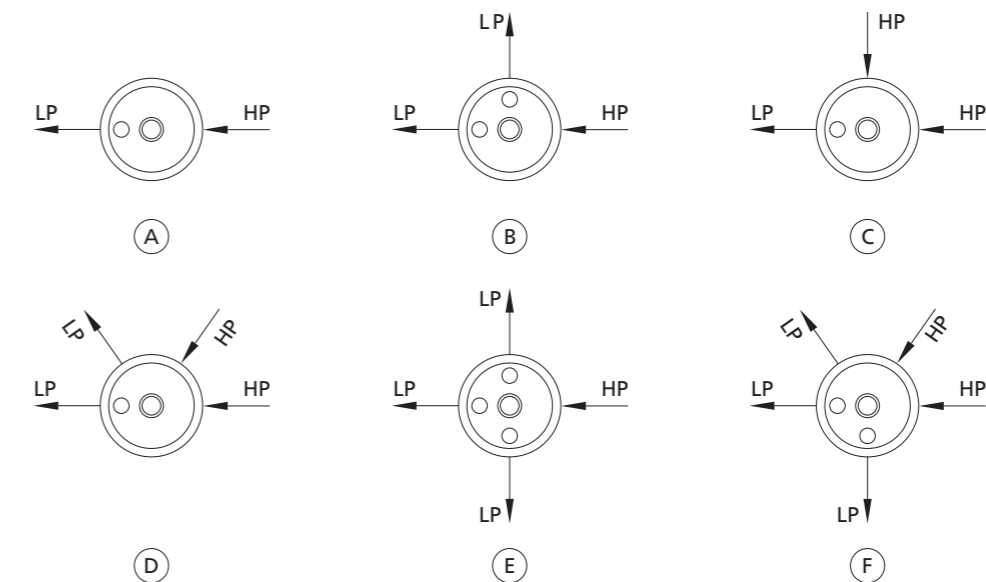

Dimensions

Dimensions, in. (mm), are for reference only and are subject to change.

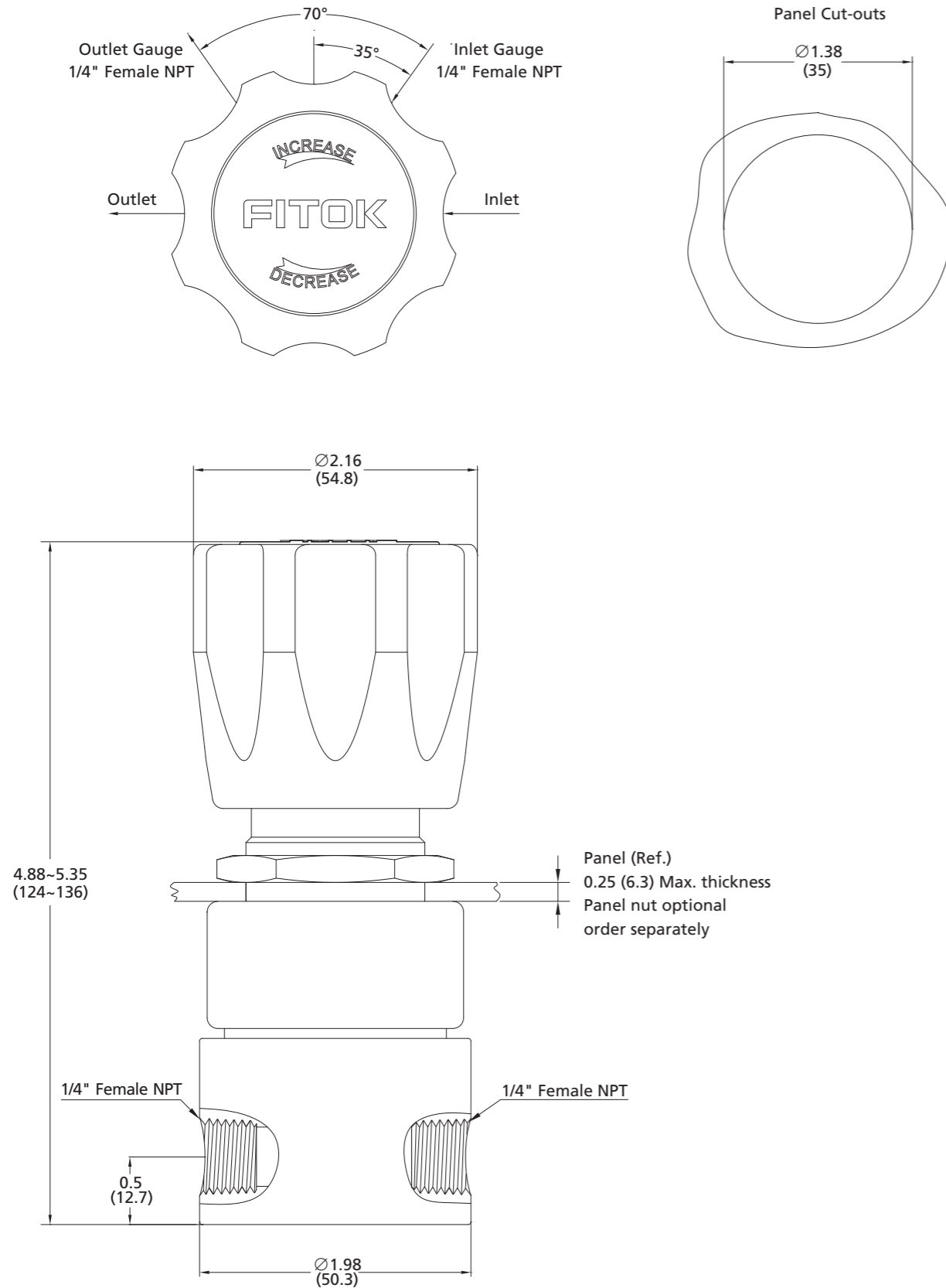

Ordering Number



Basic Ordering Number	Porting Configurations	Cv	Max. Inlet Pressure (psig)	Outlet Pressure Range (psig)
PH □ -D64MM-FL4-Y	D	0.1	6000	0~2500
PH □ -D53PP-FL4-FNS4		0.06	3000	0~1500
PH □ -D53BP-FNS4				
PH □ -F61MM-ML6-FL4-R	F		6000	0~250

Basic Ordering Number	Porting Configurations	Cv	Max. Inlet Pressure (psig)	Outlet Pressure Range (psig)
PH □ -A64WW-FL4-Z	A	0.06	6000	0~2500
PH □ -B62WB-FNS4	B			0~500
PH □ -C63PW-ML6	C			0~1500
PH □ -E52WM-FNS4-FL4-R	E		3000	0~500

Note: The others are available, please contact FITOK group or authorized agent for the others.

Part Number Description

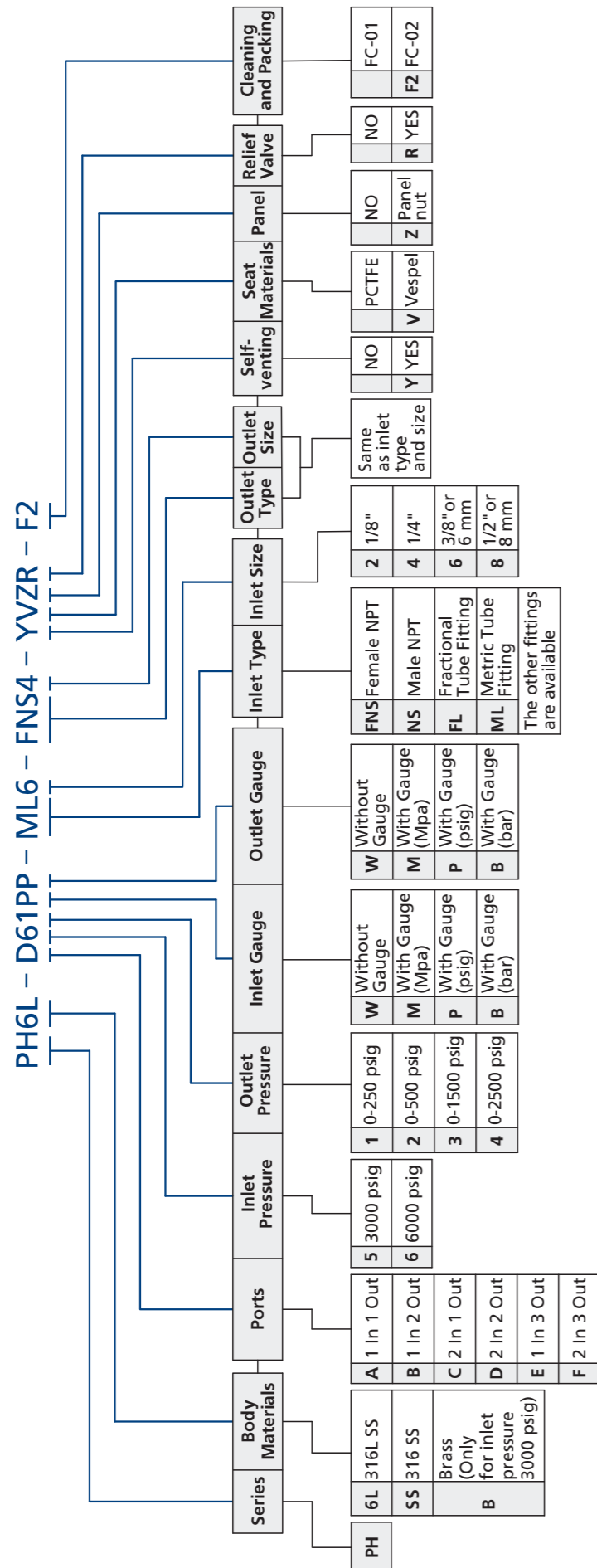

Note:

- "Part Number Description" is used for composition rules of FITOK product model, not suitable for specific product part number selection, not random combinations;
- The ports from body are 1/4" Female NPT, the other port types and sizes could be chosen with adapters, for further detail, please contact FITOK group or authorized agent;
- Gauge configurations description for regulator:
Pay attention to the ordering number cause the ports from body for gauges are one part of the total number.
For further detail, please read the stylebook of gauge or contact FITOK group;
- Cleaning and Packing:
FC-01: Normal industry standard cleaning and packaging.
FC-02: Special cleaning and packaging, following ASTM G93 level C.

Two - stage Pressure Reducing Regulator PD Series

PD series, Dual-stage diaphragm construction, stainless steel diaphragm pressure transmission, output stability, applied to pure gases, corrosive gases and non-corrosive gases.

Features

- Accurate and stable outlet pressure
- Two-stage pressure reducing construction
- Diaphragms are convoluted for greater accuracy and sensitivity
- Filter installed in inlet
- Panel mounting available

Technical Data

- Maximum inlet pressure: 3000 psig
- Outlet pressure ranges: 0~25, 0~50, 0~100, 0~150, 0~250 psig
- Flow coefficient (Cv):0.05
- Working temperature: -40°F~+165°F (-40°C~+74°C)
- Leak rate:
Internal: Bubble-tight
External: $\leq 2 \times 10^{-8}$ atm · cc/sec He
- Weight: ≈ 3.08 lbs (1.4 Kg)
- Ports: Inlet, Outlet, Gauge, Relief valve — 1/4" Female NPT



Flow Charts

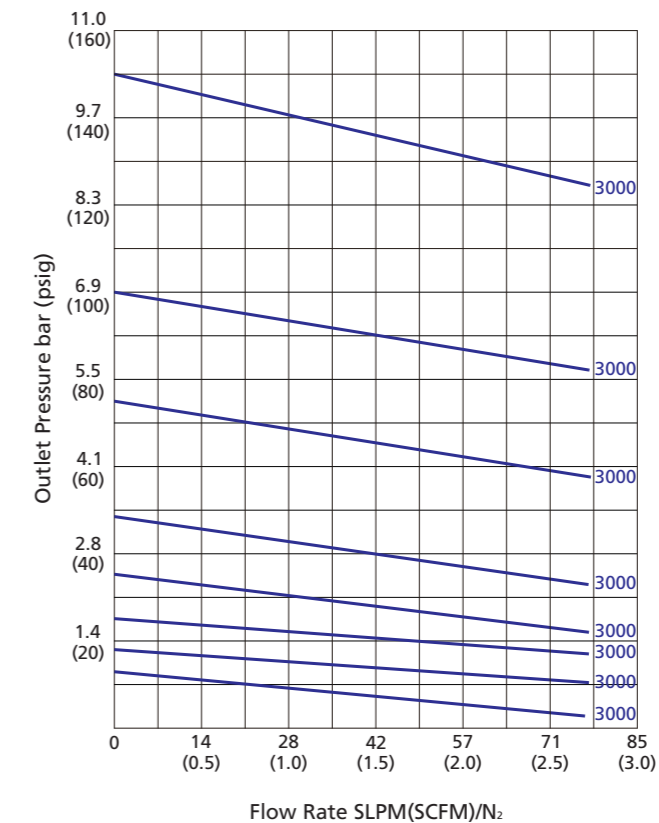

Normal Materials of Construction

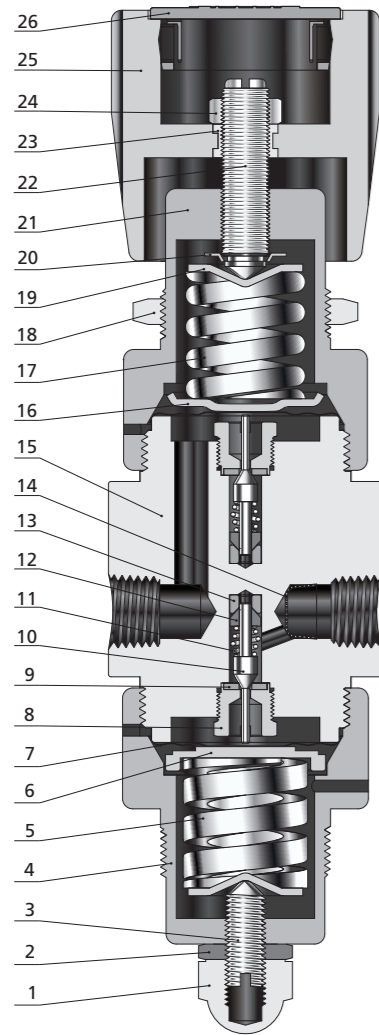

Component		Material Grade/ASTM Specification
1	Antitamper nut	304 SS/A276
2	Primary nut	304 SS/A276
3	Primary stem	304 SS/A276
4	Primary bonnet	304 SS/A276
5	Range spring	Alloy
6	Primary stop plate	304 SS/A276
7	Diaphragm	316L SS/A240
8	Seat retainer	316L SS/A276
9	Seat	PCTFE/D1430
10	Lift poppet	316L SS/A276
11	Poppet spring	316L SS/A313
12	Poppet damper	PTFE/D1710
13	Friction sleeve	316L SS/A276
14	Filter	316L SS
15	Body	316L SS/A479
16	Stop plate	304 SS/A240
17	Range spring	Alloy
18	Mounting nut	304 SS/A276
19	Spring button	304 SS/A240
20	Lock ring	304 SS/A240
21	Bonnet	304 SS/A479
22	Stem	C36000/B16
23	Embedded nut	C36000/B16
24	Stem nut	C36000/B16
25	Knob handle	ABS
26	Hole plug	ABS

Porting Configurations

2 Configurations as follows: D and F. All ports are 1/4" Female NPT.

HP: High pressure inlet LP: Low pressure outlet

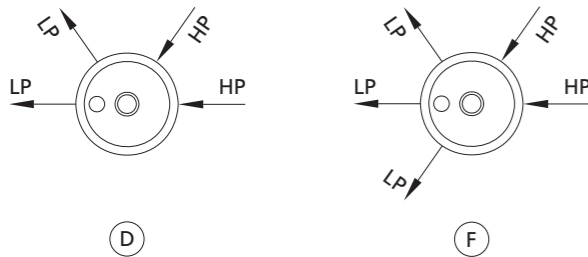

Dimensions

Dimensions, in. (mm), are for reference only and are subject to change.

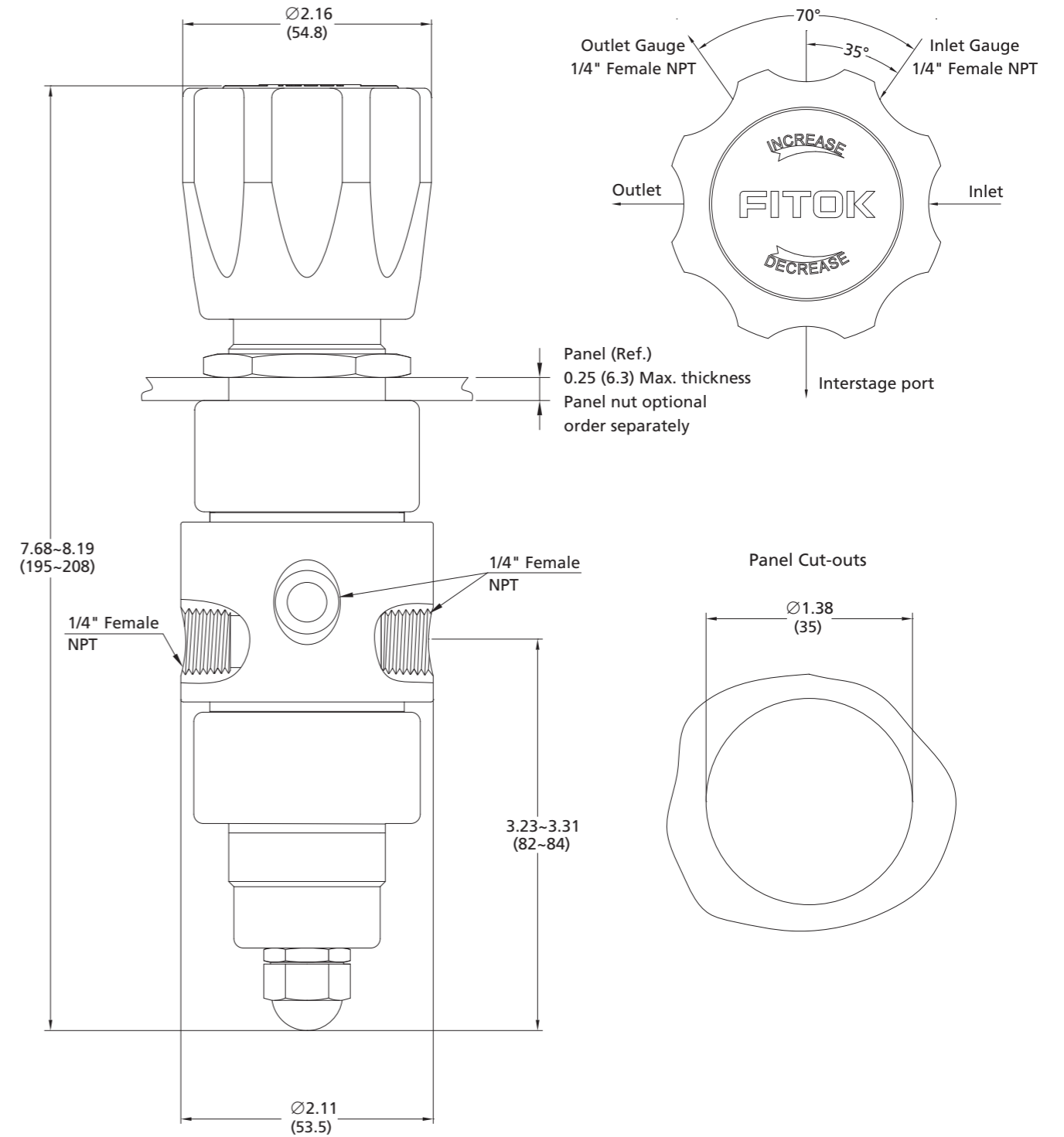

Ordering Number



Basic Ordering Number	Porting Configurations	Cv	Max. Inlet Pressure (psig)	Outlet Pressure Range (psig)
PD □ -F64MM-G10C-FL4-R-F2	F	0.05	3000	0~150
PD □ -F63PP-G10-FNS4-R				0~100
PD □ -F62BB-G10CLH-ML6-R				0~50

Basic Ordering Number	Porting Configurations	Cv	Max. Inlet Pressure (psig)	Outlet Pressure Range (psig)
PD □ -D64MM-ML6	D	0.05	3000	0~150
PD □ -D65PP-FL4-FNS4				0~250
PD □ -F63BP-FNS4-R	F			0~100

Basic Ordering Number	Porting Configurations	Cv	Max. Inlet Pressure (psig)	Outlet Pressure Range (psig)
PD □ -D62WW-FNS4-Z	D	0.05	3000	0~50
PD □ -F61WW-FNS4-R	F			0~25
PD □ -D64WW-FL4	D			0~150

Note: The others are available, please contact FITOK group or authorized agent for the others.

Part Number Description

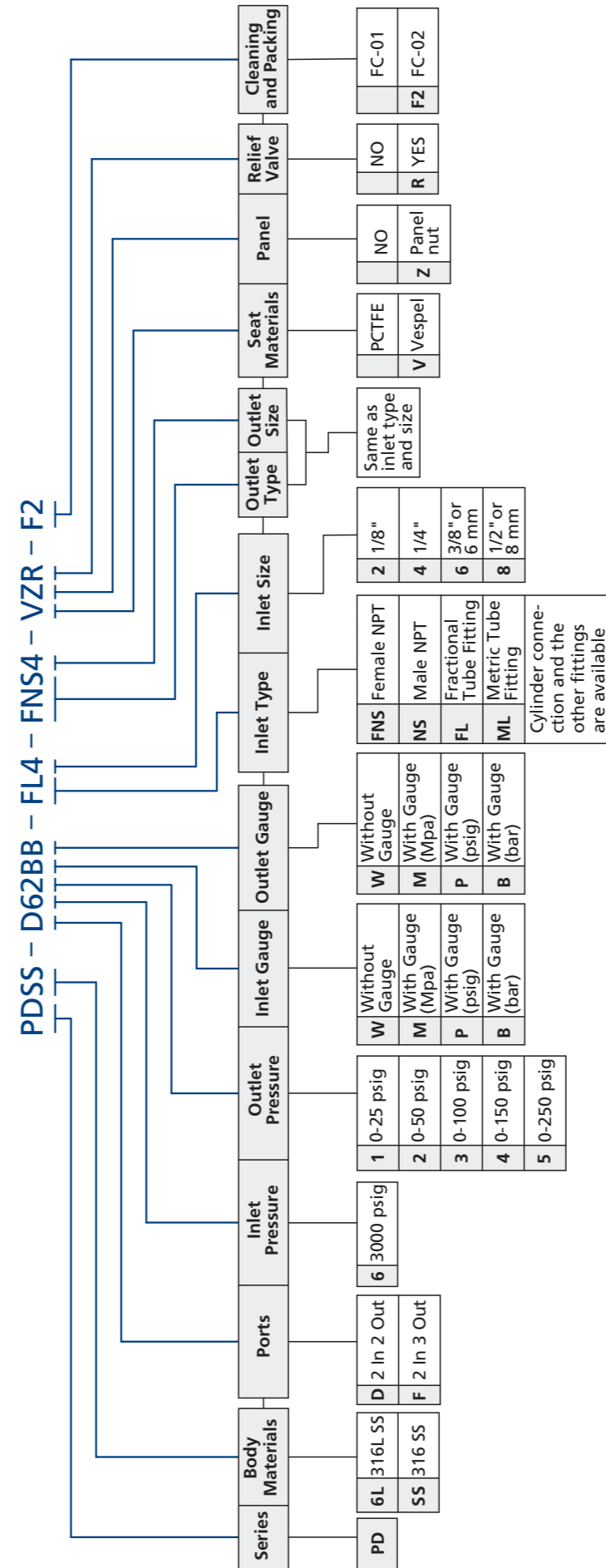

- Note:
1. "Part Number Description" is used for composition rules of FITOK product model, not suitable for specific product part number selection, not random combinations;
 2. The ports from body are 1/4" Female NPT, the other port types and sizes could be chosen with adapters, for further detail, please contact FITOK group or authorized agent;
 3. For information of gauges, please read the stylebook of gauge or contact FITOK group;
 4. Cleaning and Packing:
 FC-01: Normal industry standard cleaning and packaging.
 FC-02: Special cleaning and packaging, following ASTM G93 level C.

High Flow Pressure Reducing Regulator

PL Series

PL series, single-stage diaphragm construction, stainless steel diaphragm pressure transmission, output stability, are mainly used in the low pressure gas systems with high flow.

Features

- ⦿ 316 stainless steel body
- ⦿ Large diameter convoluted diaphragm for increased pressure sensitivity
- ⦿ Metal-to-metal diaphragm seal
- ⦿ Large flow, minimal droop
- ⦿ Panel mounting available

Technical Data

- ⦿ Maximum inlet pressure: 500 psig
- ⦿ Outlet pressure ranges: 0~15, 0~30, 0~75, 0~150 psig
- ⦿ Flow coefficient (Cv): 1.8
- ⦿ Working temperature: -40°F~+165°F (-40°C~+74°C)
- ⦿ Leak rate:
 - Internal: Bubble-tight
 - External: $\leq 2 \times 10^{-8}$ atm · cc/sec He
- ⦿ Weight: ≈ 5.95 lbs (2.7 Kg)
- ⦿ Ports: Inlet, Outlet — 3/4" Female NPT
Gauge, Relief valve — 1/4" Female NPT



Normal Materials of Construction

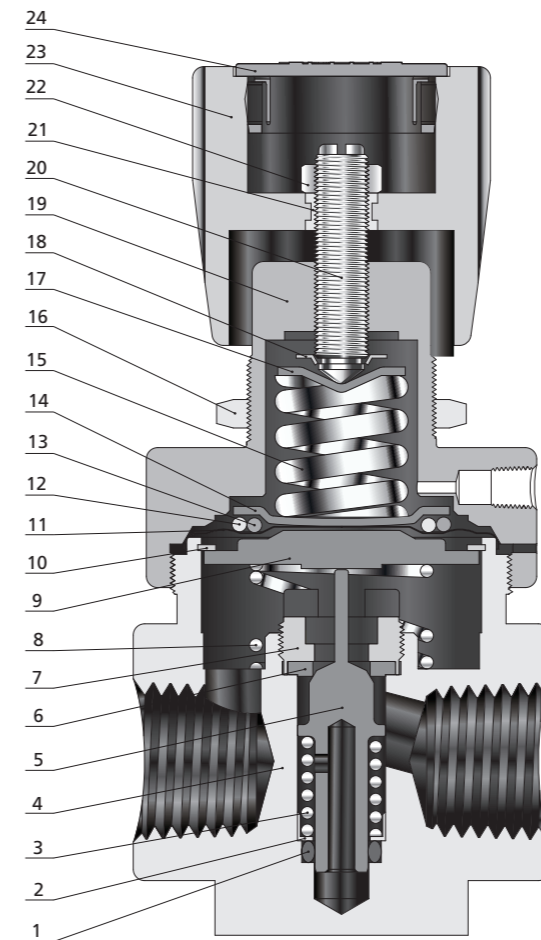

Component		Material Grade/ASTM Specification
1	Oriented ring	PTFE/D1710
2	Spring washer	316L SS/A276
3	Poppet spring	316 SS/A313
4	Body	316L SS/A479
5	Lift poppet	316L SS/A276
6	Seat	PCTFE/D1430
7	Seat retainer	316L SS/A276
8	Reset spring	316 SS/A313
9	Cushioning plate	316L SS/A276
10	Light stretch block	316 SS
11	Diaphragm	316L SS/A240
12	O-ring	PTFE/D1710
13	O-ring	PTFE/D1710
14	Stop plate	304 SS/A240
15	Range spring	Alloy
16	Mounting nut	304 SS/A276
17	Spring button	304 SS/A240
18	Lock ring	304 SS/A240
19	Bonnet	304 SS/A479
20	Stem	C36000/B16
21	Embedded nut	C36000/B16
22	Stem nut	C36000/B16
23	Knob handle	ABS
24	Hole plug	ABS

Flow Charts

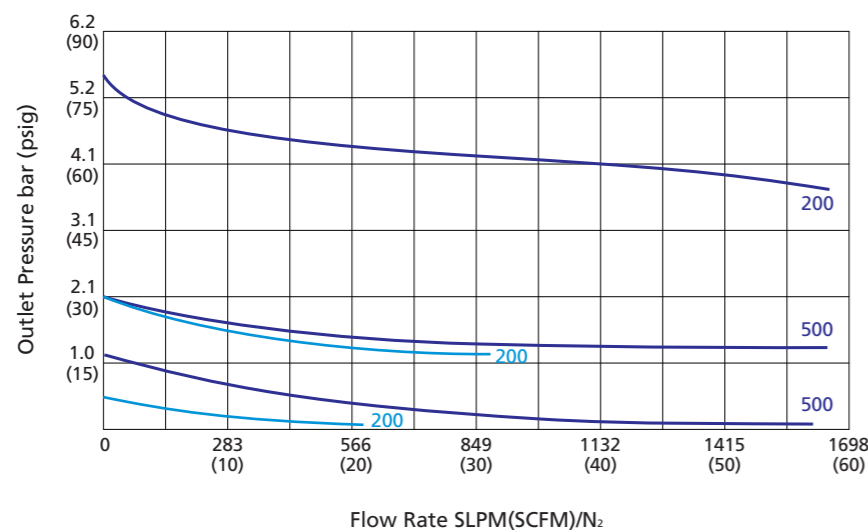

Porting Configurations

6 Configurations as follows: A, B, C, D, E and F. The horizontal inlet and outlet is both 3/4" Female NPT, the other ports are 1/4" Female NPT.

HP: High pressure inlet LP: Low pressure outlet

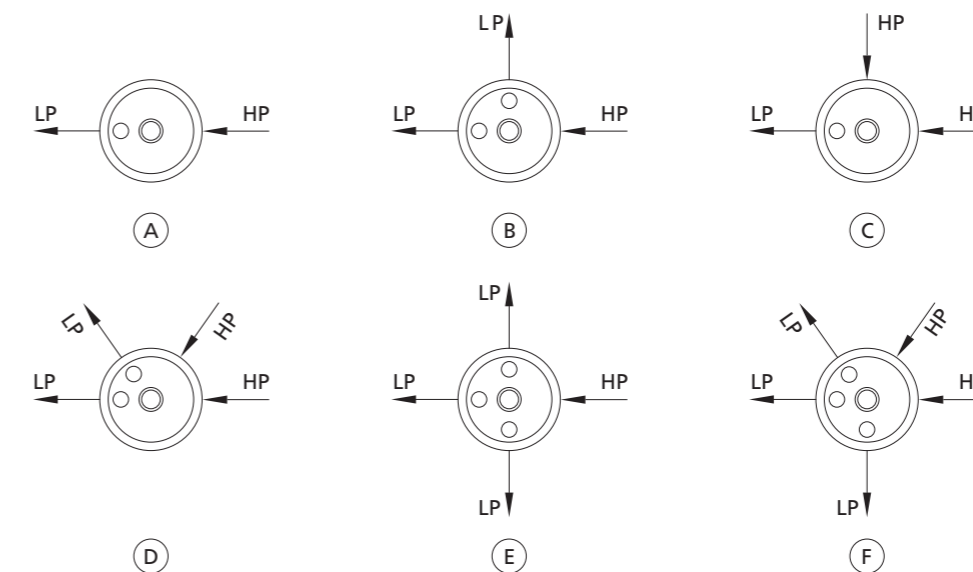

Dimensions

Dimensions, in. (mm), are for reference only and are subject to change.

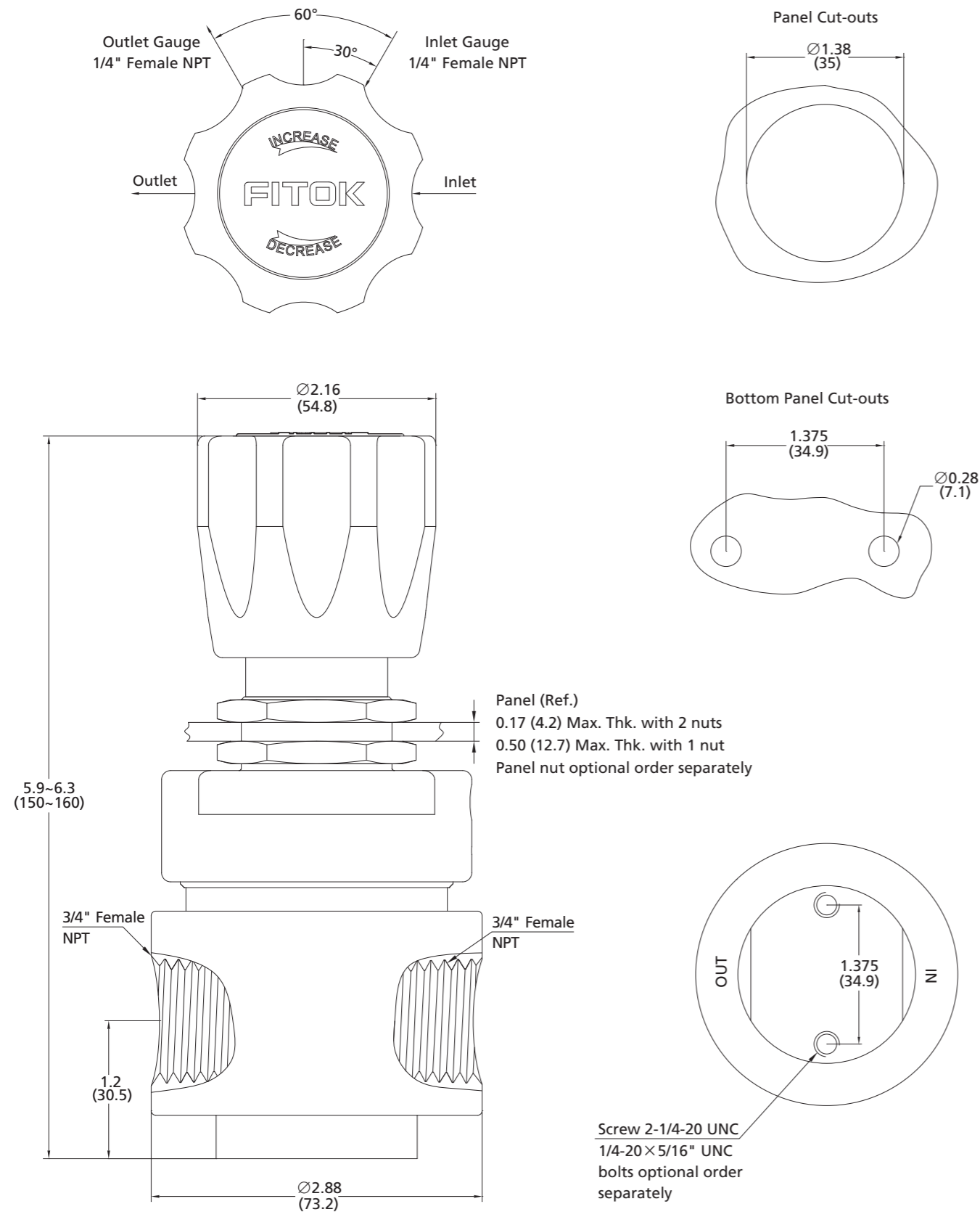

Ordering Number

Basic Ordering Number	Porting Configurations	Cv	Max. Inlet Pressure (psig)	Outlet Pressure Range (psig)
PL □ -D52PP-FNS12-F2	D	1.8	500	0~30
PL □ -F53BB-FL8-R	F			0~75

Basic Ordering Number	Porting Configurations	Cv	Max. Inlet Pressure (psig)	Outlet Pressure Range (psig)
PL □ -A51WW-ML18-Z	A	1.8	500	0~15
PL □ -B53WM-FNS12-N	B			0~75
PL □ -C52PW-FNS12-FL12	C			0~30
PL □ -E54WB-FNS12-R	E			0~150

Note: The others are available, please contact FITOK group or authorized agent for the others.